

# T102-0437 宗地用地红线外市政道路海城北街地上地下空间开发利用规划设计方案

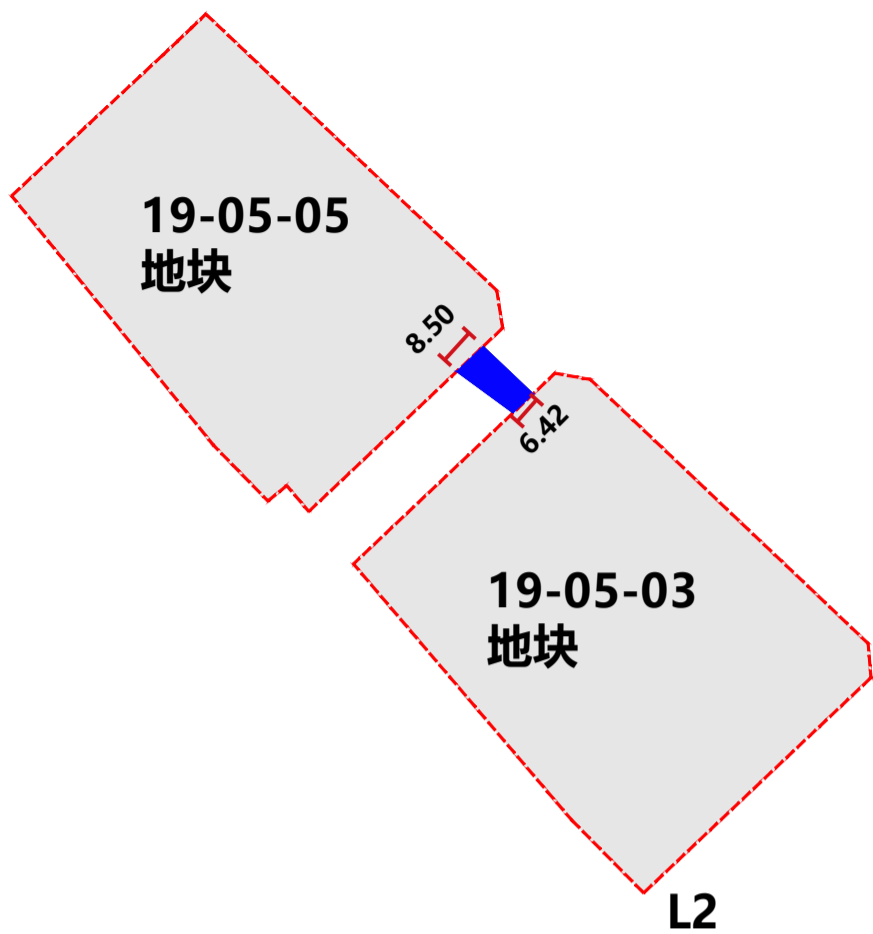

L2, 黄海高程 11.600 至 13.650 米范围内  
设置宽 $\leq 8.50\text{m}$  的地上二层连廊, 用地面积  
约  $119.31\text{ m}^2$ 。

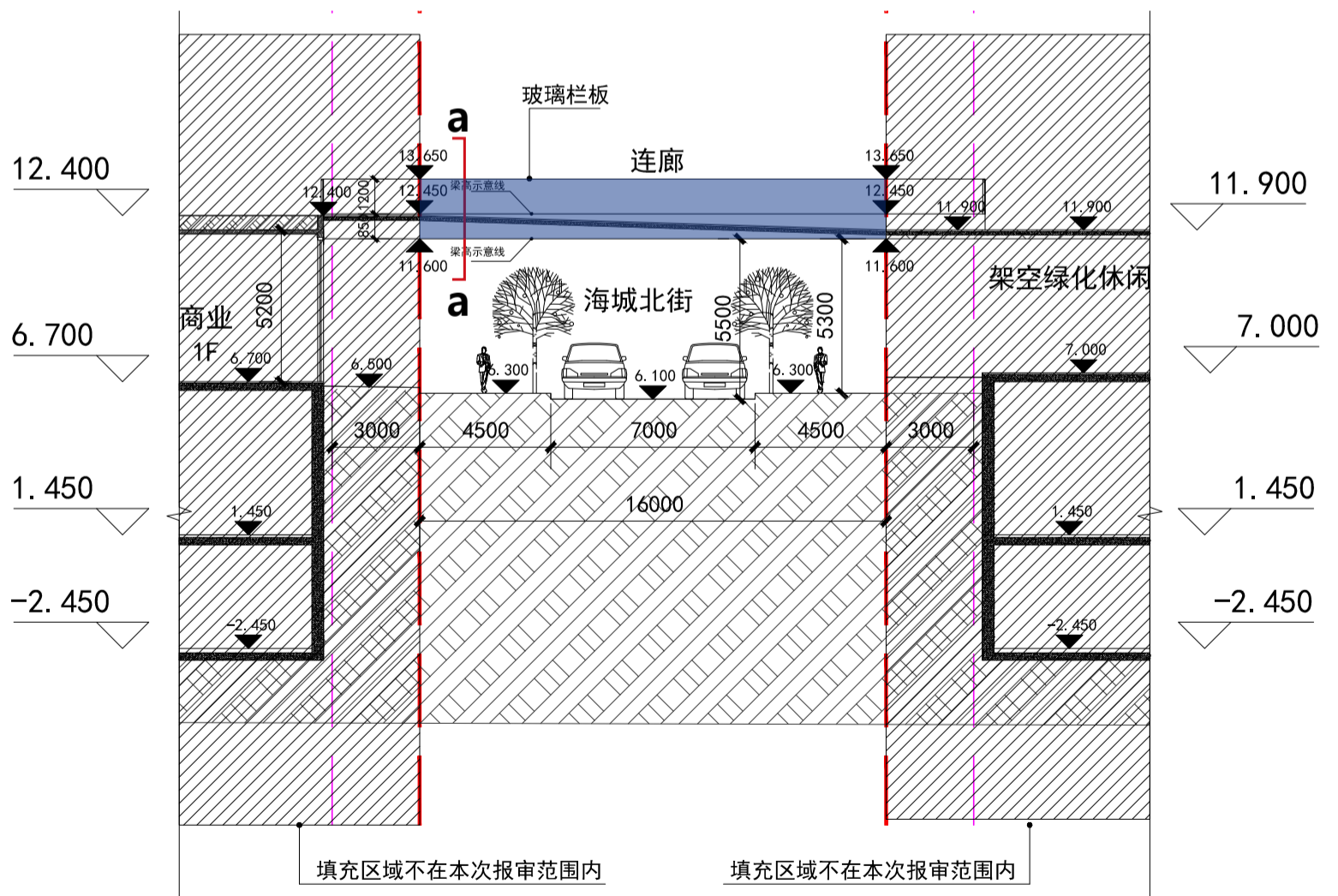
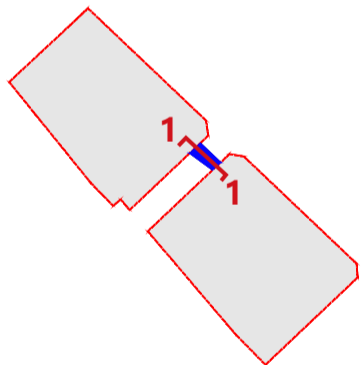
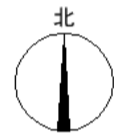

1-1 剖面图

图例

- 地上二层连廊
- T102-0437 宗地

a-a 剖面图

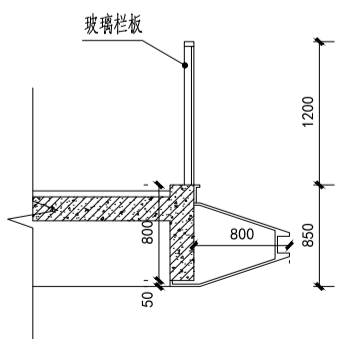

# T102-0437 宗地用地红线外市政道路海城北街地上地下空间开发利用规划设计方案

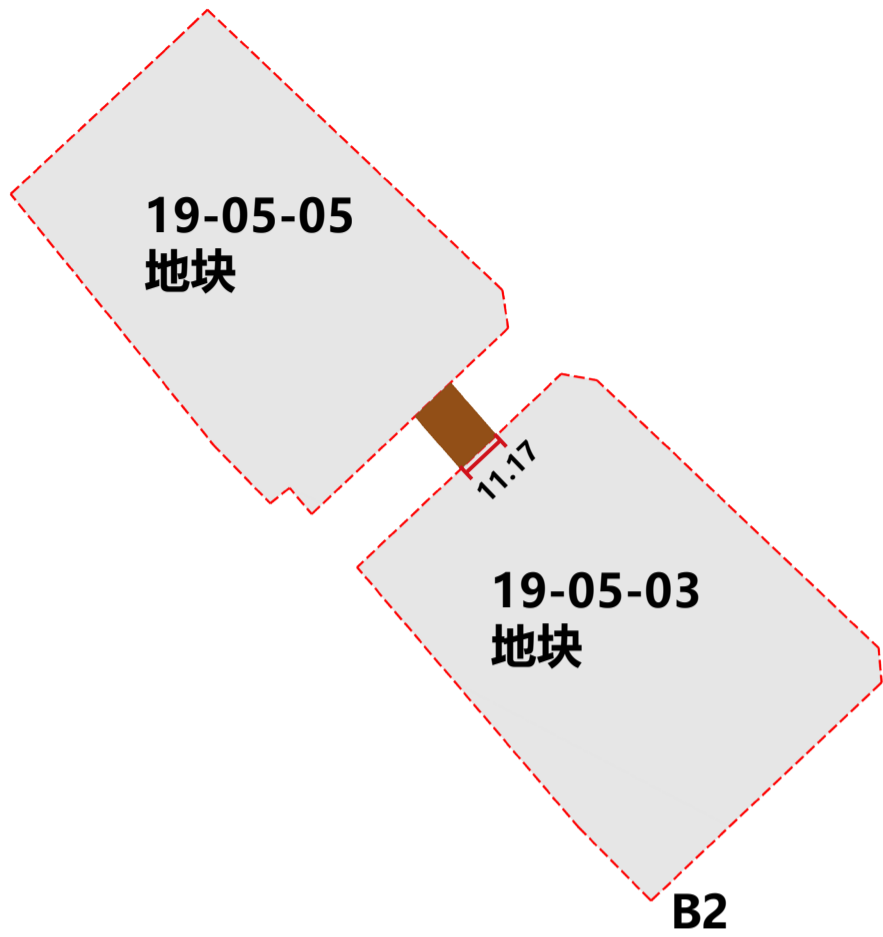

海城北街

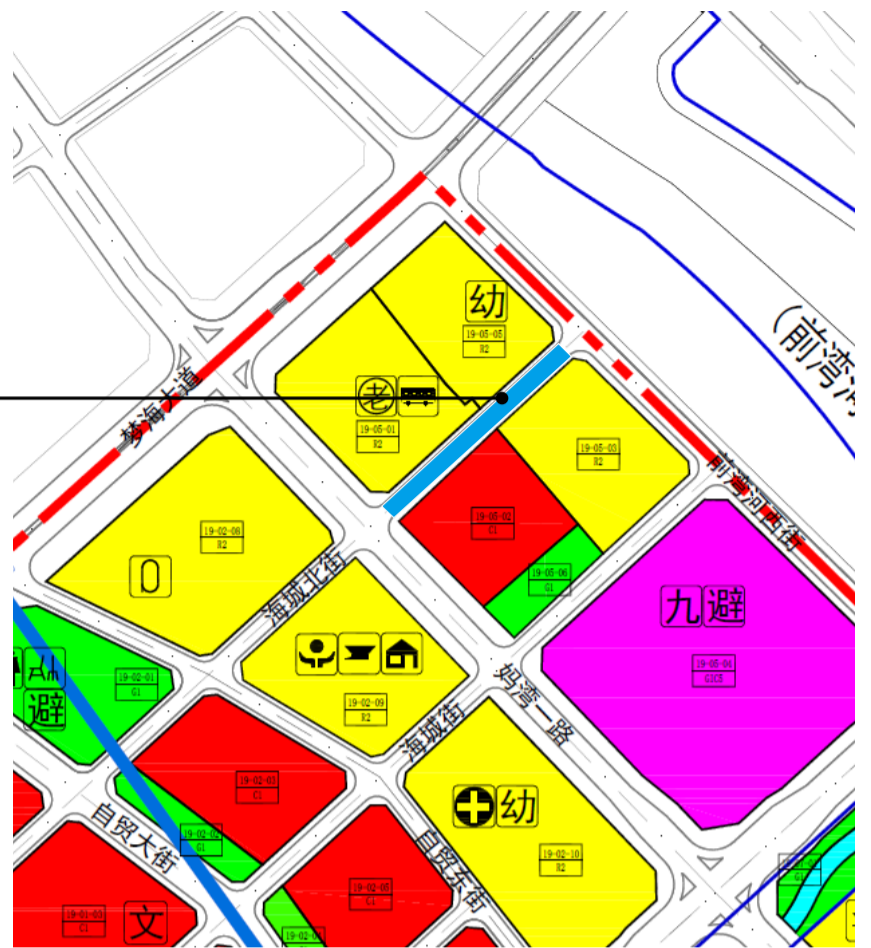

区位示意图

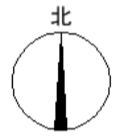

B2, 黄海高程 -2.850 至 2.100 米范围内  
设置宽 $\leq 11.17\text{m}$  的地下二层连廊, 用地面积约  $178.29\text{ m}^2$ , 建筑面积约  $178.29\text{ m}^2$

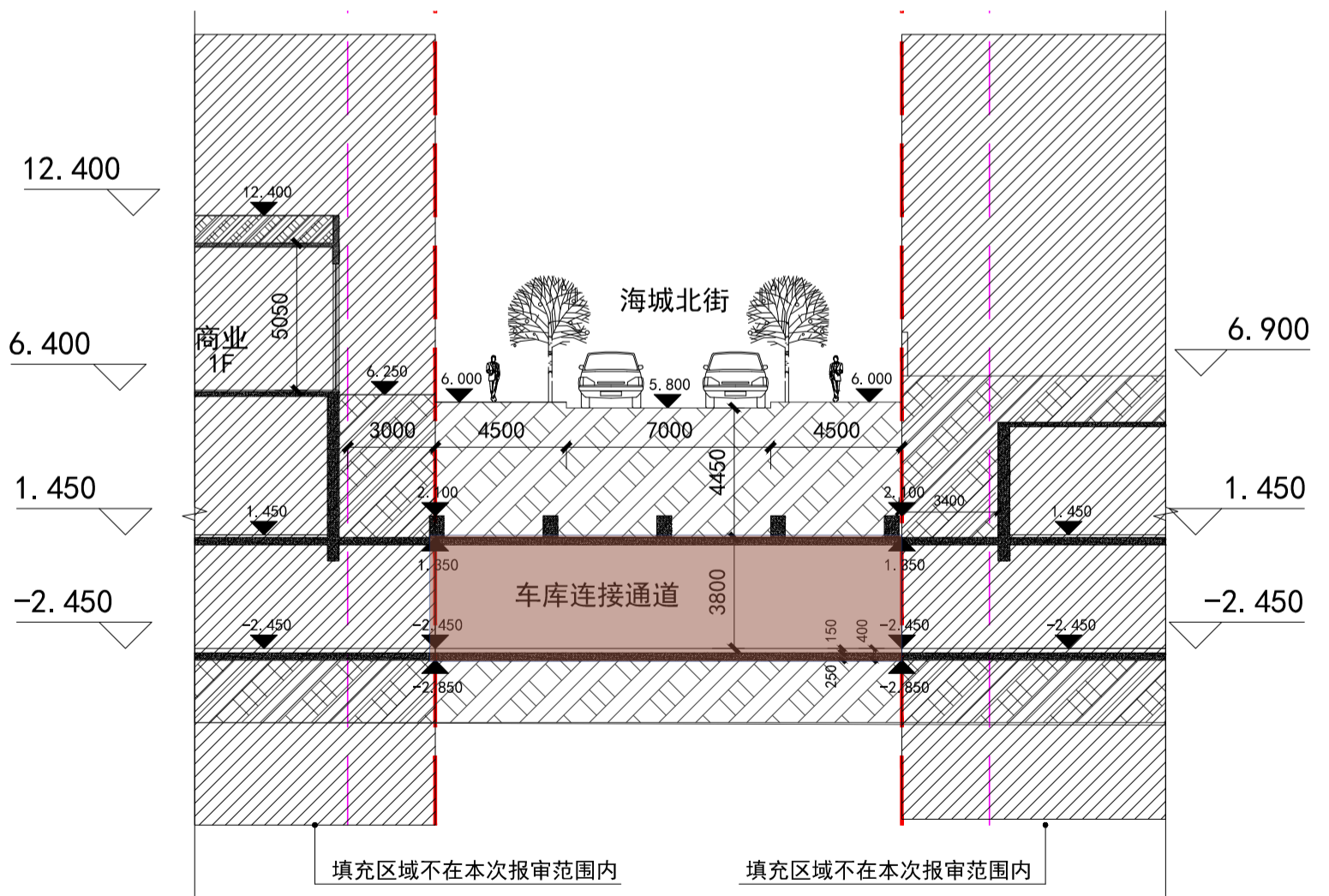
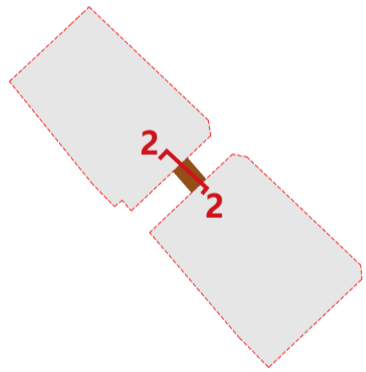

2-2 剖面图

图例

-  地下二层连接通道
-  T102-0437 宗地